

| 718 SERIES

CLAMSHELL FOR CSP/BGA PACKAGES

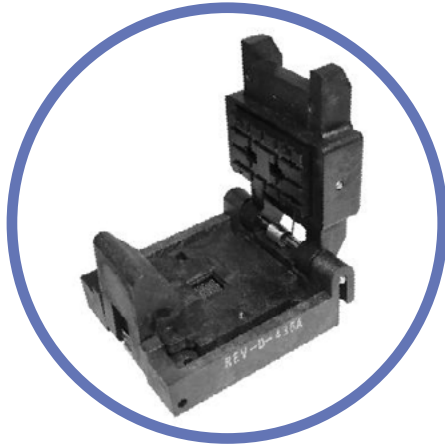

Features

- Clamshell design, compression surface mount
- Spring and probe contact
- Pointed probe maintains continuous contact to PCB
- Spring loaded pressure pad and locator plate
- Multi-site options are available
- Any pitch or pitch combination .4mm and greater
- Threaded inserts available
- Available with high performance pin



SPECIFICATIONS

Materials and Specifications

Body Materials	PEI, PES, or Equivalent
Contact Material	Beryllium Copper Alloy
Contact Plating	Gold over Nickel
Contact Force	12-15 grams average
Contact Resistance	350 mΩ typical
Temperature Rating	Burn-in 125°C Higher Temperatures, consult factory
Durability	10,000 cycles min.

Pitch e (mm)	Maximum Lead Count	Minimum Body Size	Maximum Body Size	Maximum Matrix
0.50	484	1 x 1*	16 x 14	22 x 22
0.65	441	1 x 1*	16 x 14	21 x 21
1.00	121	1 x 1*	16 x 14	11 x 11

* For package size less than 1 x 1, consult factory
For all other pitches, see next page

Pitch e (mm)	Package Size (mm)	Matrix	Part Number
0.50	0.9X0.9	2X2	718-00401L504-XX
	1.40X0.90	3X2	718-00601W504-XX
	1.57X1.09	3X2	718-00601V504-XX
	1.90X0.90	4X2	718-00801F504-XX
	1.90X1.40	4X3	718-01201Y504-XX
	2X2	4X4	718-01602-5XX-XX
	2X2.5	4X3	718-01202L504-XX
	2.5X2.5	4X4	718-01502A-5XX-XX
	2.51X1.51	5X3	718-01502F504-XX-01
	2.64X2.56	5X5	718-02502A502-XX
	2.98X2.47	6X5	718-03002M504-XX
	3X2.5	5X4	718-02003F504-XX
	3.36X3.36	6X6	718-03203B5XX-XX-01*
	3.5X3.5	6X6	718-03603C504-XX
	3.57X3.57	6X6	718-03303HS04-XX-01
	3.97X3.97	8X8	718-06403E504-XX-01
	4X4	4X4	718-01604-9XX-XX
	4X4	7X7	718-048004-5XX-XX
	4X4	7X7	718-04904-5XX-XX
	4.27X4.27	7X7	718-04804C5XX-XX
	4.35X4.2	7X7	718-04704A5XX-XX
	4.42X4.42	8X8	718-06304D5XX-XX-01
	4.5X4.5	8X8	718-06004HS04-XX
	4.76X3.41	8X5	718-04004F504-XX-02
	4.88X3.53	8X5	718-04004J504-XX-S1
	5X5	9X9	718-04805-504-XX
	5X5	9X9	718-05705-504-XX
	5X5	9X9	718-05705-504-XX-01
	5X5	9X9	718-05705-504-XX-02
	5X5	8X8	718-06405-5XX-XX
	5X5	9X9	718-08005-5XX-XX
	5X5	9X9	718-08005-504-XX
	5X5	9X9	718-08105-5XX-XX
	5.07X3.06	9X5	718-04205CXX-XX-01
	5.5X5.5	10X10	718-08705E504-XX
	5.81X5.56	10X10	718-09305K504-XX
	5.8X5.4	11X10	718-08806L504-XX-01

Pitch e (mm)	Package Size (mm)	Matrix	Part Number
0.50	5.9X5.1	10X8	718-07205J504-XX
	6X3.5	10X6	718-05606K50X-XX
	6X5	11X6	718-04806G504-XX
	6X5	11X6	718-04806G504-XX
	6X6	9X9	718-04906-5XX-XX
	6X6	10X10	718-05606-5XX-XX
	6X6	10X10	718-06406-5XX-XX
	6X6	8X8	718-06406-5XX-XX
	6X6	10X10	718-06806-504-XX-01
	6X6	10X10	718-08006-5XX-XX-01
	6X6	10X10	718-08406-5XX-XX
	6X6	10X10	718-08406-504XX-01
	6X6	10X10	718-08406-50X-XX
	6X6	11X11	718-08806-5XXXX
	6X6	10X10	718-08806-504-XX-01
	6X6	11X11	718-09606-5MM
	6X6	11X11	718-10406-5J00(X-01
	6X6	11X11	718-10506-5XX-XX
	6X6	11X11	718-11106-5XX-XX
	6X8	14X8	718-04408A504-XX
	6.29X10.53	4X10	718-04010A-502-XX
	7X7	11X11	718-07207-502XX
	7X7	11X11	718-07207-504XX
	7X7	12X12	718-08407-502XX
	7X7	13X13	718-08807-5XX-XX
	7X7	12X12	718-10007-5XX-XX-01
	7X7	12X12	718-10007-504-XX-01
	7X7	12X12	718-10807-5XXXX
	7X7	12X12	718-10807-504-XX-01
	7X7	12X12	718-10807-504XX-01
	7X7	12X12	718-11207-504-XX-01
	7X7	12X12	718-12007-504-XX-01
	7X7	11X11	718-12107-504XX
	7X7	12X12	718-14307-502-XX
7X7	12X12	718-14407-504XX	
7X7	13X13	718-14407-504-XX	
7X7	12X12	718-14407-504XX	
7.06X3.25	8X6	718-04807B5XX-XX	

Pitch e (mm)	Package Size (mm)	Matrix	Part Number
0.50	8X8	14X14	718-10008-504XX
	8X8	14X14	718-10808-5XX-XX
	8X8	14X14	718-10808-5XX-XX
	8X8	14X14	718-11608-5XX-XX
	8X8	13X13	718-12808-502-XX
	8X8	14X14	718-13208-504XX-01
	8X8	14X14	718-14408-502-XX
	8X8	14X14	718-14408-5XXX-01
	8X8	14X14	718-14408-504-XX-01
	8X8	14X14	718-15208-504XX
	8X8	14X14	718-15908-5XX-XX
	8X8	15X15	718-16108-504-XX
	8X8	14X14	718-16408-504-XX-01
	8X8	13X13	718-16908-504XX
	8X8	15X15	718-17608-5XX-XX
	8X8	14X14	718-19608-502-XX
	8X8	14X14	718-19608-504XX-01
	8X8	15X15	718-22508-5XX-XX-01
	8.5X8	16X15	718-24008E504-XX
	8.5X8.5	16X16	718-19208D5044-XX
	8.5X8.5	16X16	718-25608D504-XX-01
	9X9	16X16	718-17608-5044-XX-01
	9X9	16X16	718-17609-504-XX-02
	9X9	17X17	718-18809-5XX-XX
	9X9	16X16	718-18809-5XX-XX
	9X9	16X16	718-18809-504-XX-01
	9X9	16X16	718-19209-504-XX
	9X9	16X16	718-25609-5044-XX-01
	9X9	17X17	718-28809-504-XX
	10.53X6.29	10X4	718-04010A5XX-XX-01
	10.9X10.1	19X19	718-28111A5XX-XX-01
	10X10	17X17	718-18110-5XX-XX
	10X10	18X18	718-18410-5XX-XX
	10X10	18X18	718-20810-5044-XX-01
	10X10	18X18	718-24010-504-XX-01
	10X10	18X18	718-24510-5044-XX-01
	10X8	14X10	718-05610D5044-XX
	11X11	17X17	718-24011-5XX-XX-01

Pitch e (mm)	Package Size (mm)	Matrix	Part Number
0.50	11X11	20X20	718-25611-5XX-XX
	12.5X7	24X13	718-22812A5XX-XX-01
	12X12	22X22	718-22812-5XX-XX
	12X12	21X21	718-24412-XXX-XX
	12X12	22X22	718-27212-5044-XX-01
	12X12	22X22	718-27612-500-XX
	12X12	19X19	718-28812-5XX-XX-01
	12X12	22X22	718-29112-5044-XX-01
	12X12	22X22	718-32412-5044-XX
	12X12	22X22	718-34412-504-XX-01
	13X13	22X22	718-30013-502-XX
	13X13	23X23	718-31613-5044-XX-01
0.65	12X12	17X17	718-20812-604-XX-01
	12X12	17X17	718-28912-604-XX-01
	12X12	18X18	718-30012-6044-XX-01
	13X13	18X18	718-24813-604-XX-01
	13X13	19X19	718-28013-6XX-XX
	13X13	19X19	718-28013-6044-XX-02
	14X12	20X17	718-19014C604-XX
	10X4.5	14X6	718-08310A6XX-XX
	5X5	7X7	718-04905-6XX-XX
	5X5	7X7	718-04905-6XX-XX
	6X6	8X8	718-06406-6044-XX-01
	8X8	11X11	718-09608-604-XX
	8X8	11X11	718-09608-604-XX-01
	8X8	11X11	718-12108-6XX-XX
	1.00	11.63X8.38	11X8
12X10		10X8	718-08012D9044-XX
7X4.5		5X3	718-01407A9044-XX
8.46X6.27		7X5	718-02108A9XX-XX



DIMENSIONS AND DIAGRAMS

Dimensions in mm (inches)

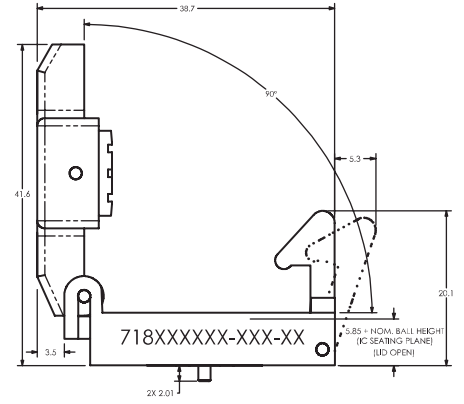
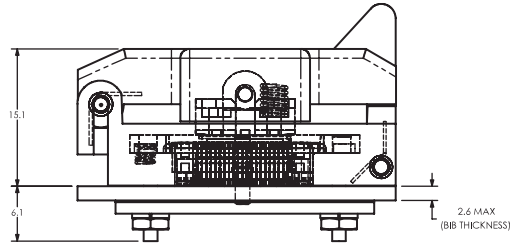
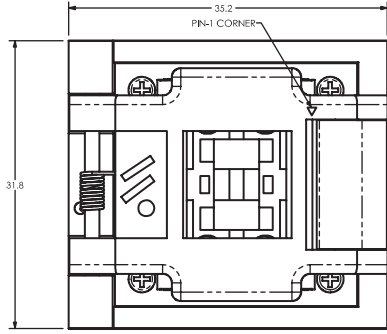

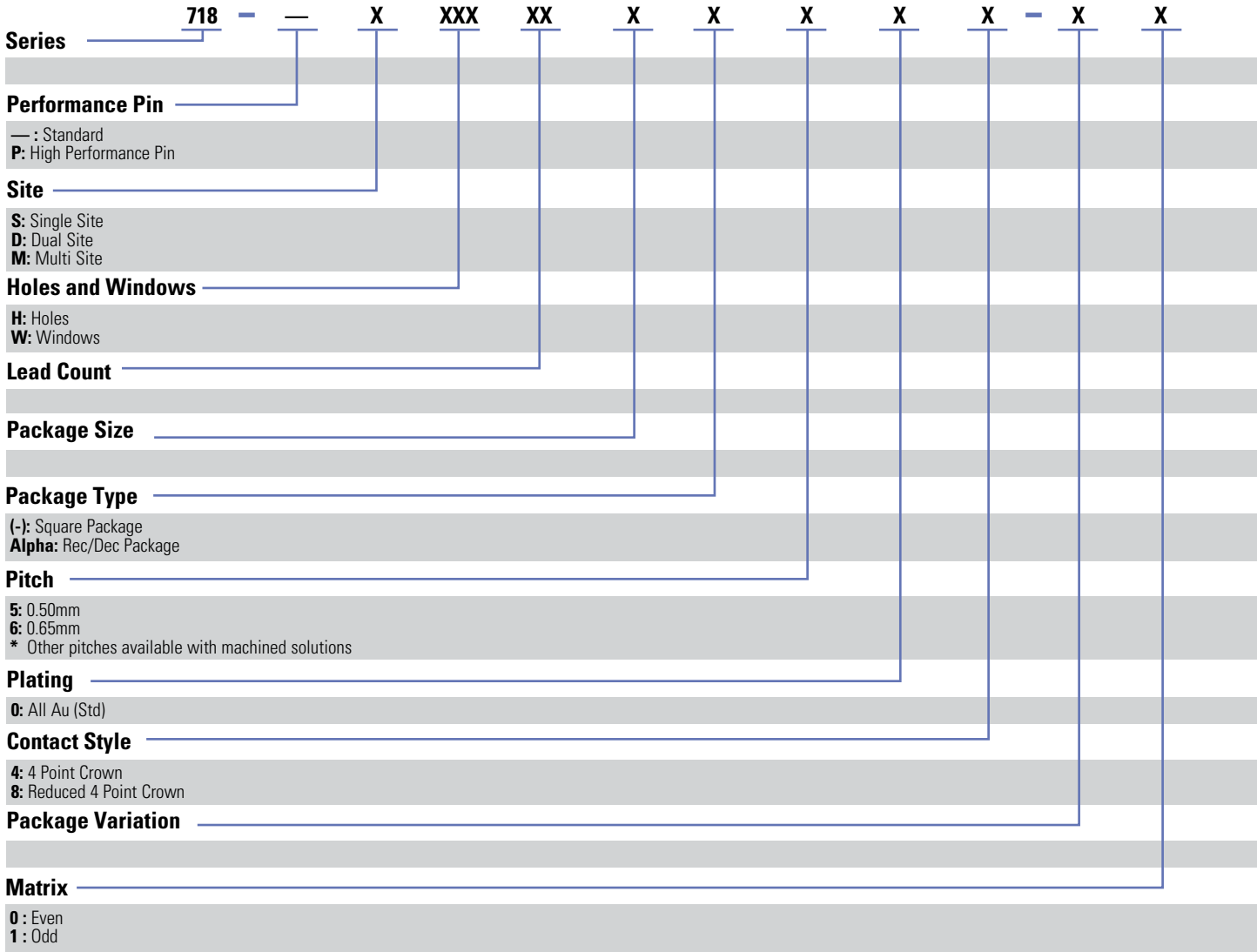

Revised 02/06/18

Sensata Technologies, Inc. ("Sensata") data sheets are solely intended to assist designers ("Buyers") who are developing systems that incorporate Sensata products (also referred to herein as "components"). Buyer understands and agrees that Buyer remains responsible for using its independent analysis, evaluation and judgment in designing Buyer's systems and products. Sensata data sheets have been created using standard laboratory conditions and engineering practices. Sensata has not conducted any testing other than that specifically described in the published documentation for a particular data sheet. Sensata may make corrections, enhancements, improvements and other changes to its data sheets or components without notice.

Buyers are authorized to use Sensata data sheets with the Sensata component(s) identified in each particular data sheet. HOWEVER, NO OTHER LICENSE, EXPRESS OR IMPLIED, BY ESTOPPEL OR OTHERWISE TO ANY OTHER SENSATA INTELLECTUAL PROPERTY RIGHT, AND NO LICENSE TO ANY THIRD PARTY TECHNOLOGY OR INTELLECTUAL PROPERTY RIGHT, IS GRANTED HEREIN. SENSATA DATA SHEETS ARE PROVIDED "AS IS". SENSATA MAKES NO WARRANTIES OR REPRESENTATIONS WITH REGARD TO THE DATA SHEETS OR USE OF THE DATA SHEETS, EXPRESS, IMPLIED OR STATUTORY, INCLUDING ACCURACY OR COMPLETENESS. SENSATA DISCLAIMS ANY WARRANTY OF TITLE AND ANY IMPLIED WARRANTIES OF MERCHANTABILITY, FITNESS FOR A PARTICULAR PURPOSE, QUIET ENJOYMENT, QUIET POSSESSION, AND NON-INFRINGEMENT OF ANY THIRD PARTY INTELLECTUAL PROPERTY RIGHTS WITH REGARD TO SENSATA DATA SHEETS OR USE THEREOF.

All products are sold subject to Sensata's terms and conditions of sale supplied at www.sensata.com SENSATA ASSUMES NO LIABILITY FOR APPLICATIONS ASSISTANCE OR THE DESIGN OF BUYERS' PRODUCTS. BUYER ACKNOWLEDGES AND AGREES THAT IT IS SOLELY RESPONSIBLE FOR COMPLIANCE WITH ALL LEGAL, REGULATORY AND SAFETY-RELATED REQUIREMENTS CONCERNING ITS PRODUCTS, AND ANY USE OF SENSATA COMPONENTS IN ITS APPLICATIONS, NOTWITHSTANDING ANY APPLICATIONS-RELATED INFORMATION OR SUPPORT THAT MAY BE PROVIDED BY SENSATA.

Mailing Address: Sensata Technologies, Inc., 529 Pleasant Street, Attleboro, MA 02703, USA.

CONTACT US

Americas
480.682.6148 or 480.681.6116